

**MAIN FLOOR**

1633 SQ. FT.

8'-4" CEILING HEIGHT

**GARAGE**

493 SQ. FT.

9'-0" CEILING HEIGHT

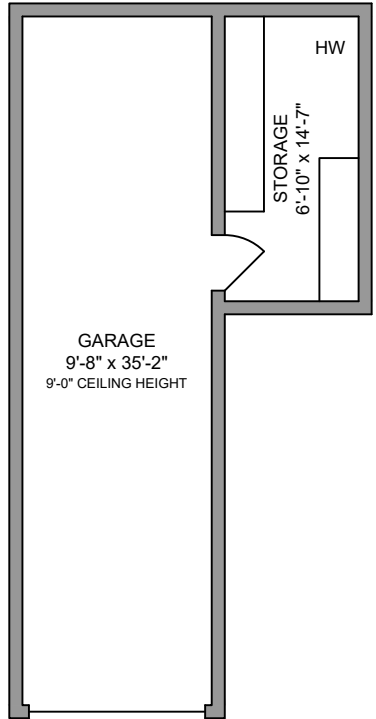

**NORTH**

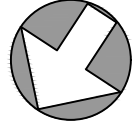
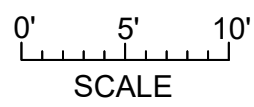

UNIT B - 2612 THORPE PLACE			
JULY 11, 2024			
PREPARED FOR THE EXCLUSIVE USE OF MARC OWEN-FLOOD			
PLANS MAY NOT BE 100% ACCURATE. IF CRITICAL BUYER TO VERIFY.			
FLOOR	AREA (SQ. FT.)		
	FINISHED	GARAGE	PATIO
UNIT B	1633	493	772

Note: This floor plan is provided by Newport Realty Ltd. as a convenient reference only, and is not to be relied upon as accurate. Prospective Buyers must satisfy themselves not only of the actual measurements, but also to the status of any finished space shown on this floor plan, specifically in relation to minimum ceiling height for habitable rooms required by the BC Building Code, allowable finished floor area in relation to current zoning, and determination if space was developed with necessary municipal permits.



**Marc Owen-Flood**  
PERSONAL REAL ESTATE CORPORATION  
Marc Owen-Flood & Associates

